

拨动开关

产品尺寸

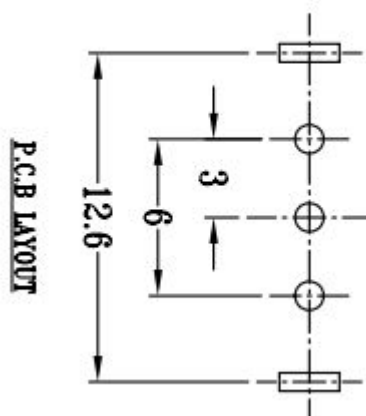

产品图片

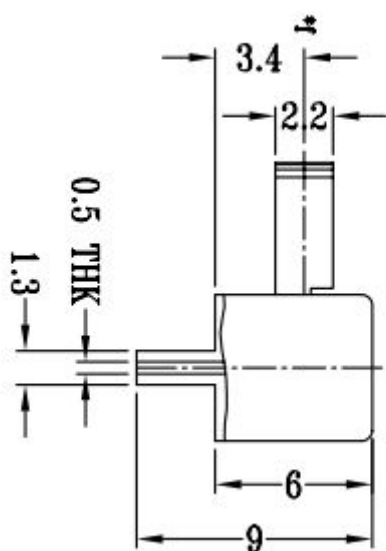
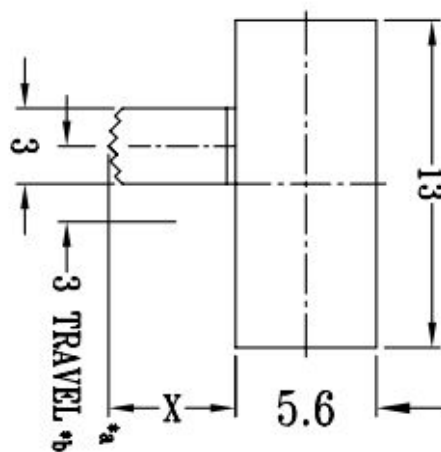
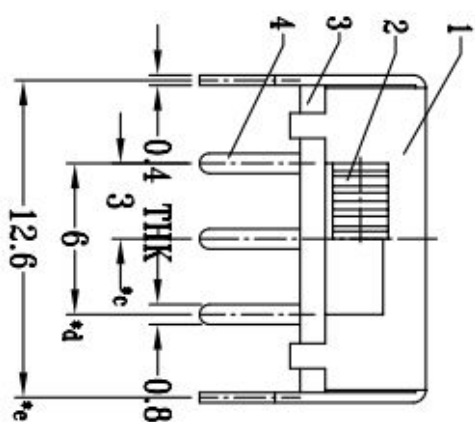
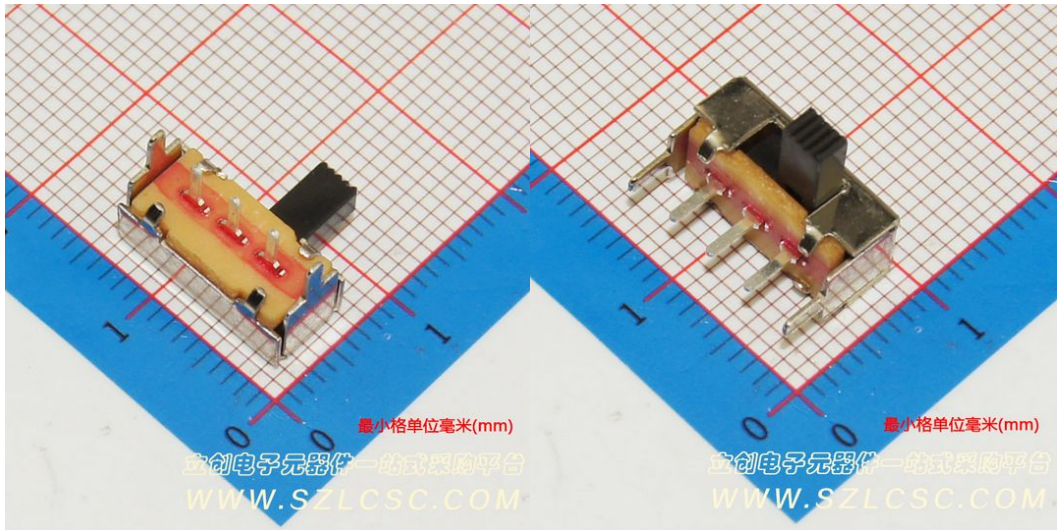

SK-12F14拨动开关额定功率：DC50V0.3A
工作温度范围：-20°C~60°C

拨动开关各方面性能：

一.电气性能规格

1.接触电阻测试：在微小电流（100mA）以下测试。

要求：必须达到30毫欧以下

要求：外观无异常,满足于机械,电器性能