

产品特性: *高亮度 *工作可靠, 寿命长 *低功耗 *兼容IC

LDS-5461AX/BX

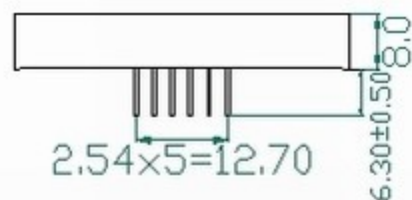

DIG.1 DIG.2 DIG.3 DIG.4

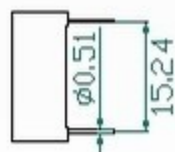
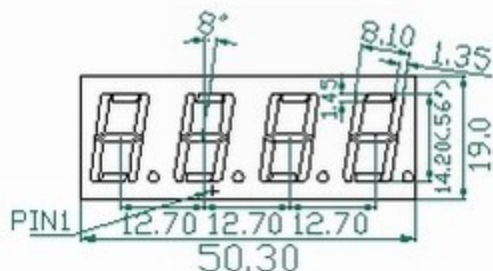

LDS-5461AX

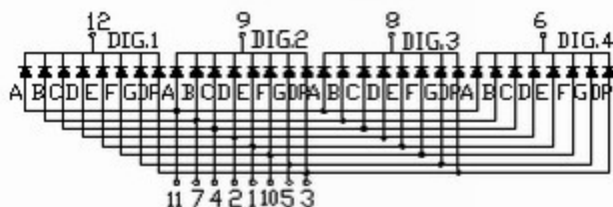

LDS-5461BX

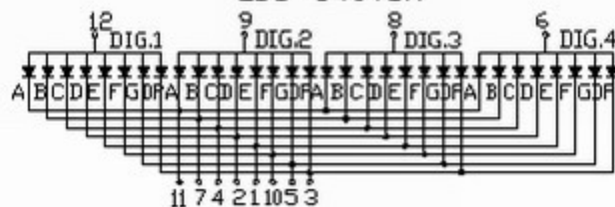

1. 尺寸单位为mm. 除特别说明外, 允许公差±0.25mm;

2. 每个PIN脚的斜度可能有±5°.