

FEATURES特点

- 5 Amps Small power relay.
5安培小型功率继电器
- Nominal power 200mW.
正常功率为200毫瓦。
- Thickness 7mm relay.
7mm 超薄型继电器
- Approved UL and TUV.
UL及TUV.安规认证



UL FILE NO.:E171095

CQS FILE NO.: CQC15002133481

CONTACT RATING 接点参数

Contact Form接点形式	1A SPST-NO
Max. Switching Power最大切换功率	1250VA
Max. Switching Voltage最大切换电压	250VAC
Max. Switching Current最大切换电流	5A
Min. Switching Current/Voltage最小切换电流/电压	100mA 5VDC
Rating Load(Resistive)额定负载(阻性)	5A 250VAC 5A 30VDC 1/8HP 240VAC
Contact Material接点材质	Ag Alloy银合金

CHARACTERISTICS 性能参数

Electrical Life 电气寿命	1 × 10 ⁵	
Mechanical Life机械寿命	1 × 10 ⁷	
Insulation Resistance绝缘阻抗	Min. 1,000MΩ 500VDC	
Contact Resistance(Initial)接触电阻	≤ 100mΩ (6VDC 1A)	
Operate Time 动作时间	≤ 20ms	
Release Time 开放时间	≤ 10ms	
Initial Dielectric Strength 耐压	between open contacts开放接点间: 50/60Hz 750VAC 1min. between contacts and coil线圈接点间: 50/60Hz 4000VAC 1min.	
Vibration Resistance 耐振动	Malfuction: 误动作:	10 ~ 55Hz Double Amplitude双振幅 1.5mm
	Damage limits: 耐久:	10 ~ 55Hz Double Amplitude双振幅 1.5mm
Shock Resistance 耐冲击	Malfuction: 误动作:	10G
	Damage limits: 耐久:	100G
Ambient Temperature环境温度	-40℃ ~ +85℃ (No freezing 无结冰)	
Relative Humidity相对湿度	85% at 40℃	
Unit Weight单位重量	约Approx. 4g	

ORDERING INFORMATION 型号代码说明

Y31 -1A - 12 D S - F - A 1 2 3 4 5 6 Z	
1. Model Number 型号 2. Contact Arrangement 接点形式 1A= 1 Form A 1组常开 3. Coil Voltage 线圈电压 5、9、12、18、24VDC 4. Coil Type 线圈形式 D=DC 直流 5. Enclosure 密封形式 S = Sealed Type 密封型 H = Washable Type 密封防水型	6. Type of Insulation 绝缘形式 Nil = Class A F = Class F 7. PCB Terminal Structure Nil = Standard type 标准型 A = A type 特殊端子型

COIL RATINGS (at 20°C) 线圈额定值 (在20°C)

COIL TYPE 线圈形式	Coil Nominal Voltage 线圈额定电压 (V)	Coil Resistance 线圈阻抗 ($\Omega \pm 10\%$)	Pick-Up Voltage 动作电压(V) (Max)	Drop-Out Voltage 开放电压(V) (Min)	Nominal Current 额定电流 (mA)
DC Coils 直流线圈 (abt. 0.2W)	5	125	3.75	0.25	40
	9	405	6.75	0.45	22.2
	12	720	9	0.6	16.7
	18	1,620	13.5	0.9	11.1
	24	2,880	18	1.2	8.6

* Max Continuous Voltage at 20°C: 130% of Coil Normal Voltage.
 最大使用电压在20°C:线圈额定电压的130%

OUTLINE DIMENSIONS 外部尺寸

UNIT: mm(inch) 单位: 毫米(英寸)

Dimensions尺寸

Internal Connections接线图
(Bottom View底视图)

Drilling Plan孔位图
(Bottom View底视图)

Standard Type 标准型

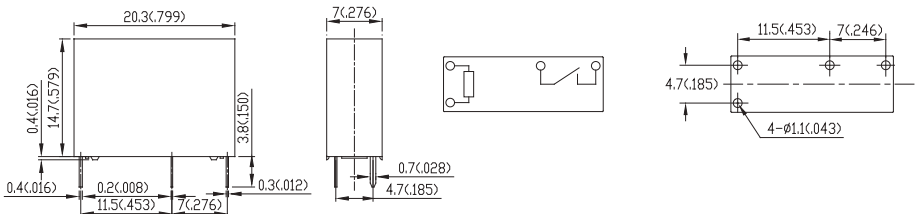

REMARK: Dimensions $\leq 5\text{mm} \pm 0.2\text{mm}$, $> 5\text{mm} \pm 0.3\text{mm}$, the tolerance of PCB thru hole: $+0.2\text{mm}$
 备注: 尺寸公差 $\leq 5\text{mm} \pm 0.2\text{mm}$, $> 5\text{mm} \pm 0.3\text{mm}$, 印刷电路板孔 $+0.2\text{mm}$

A Type 特殊端子型

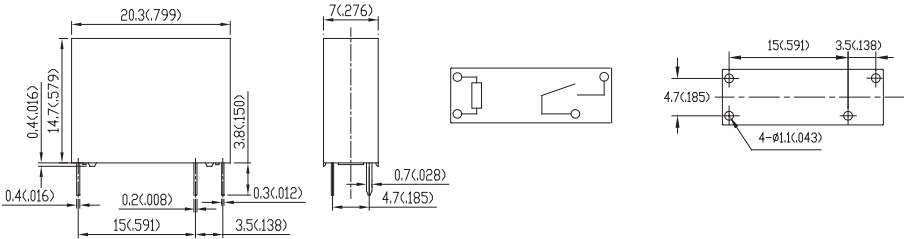

REMARK: Dimensions $\leq 5\text{mm} \pm 0.2\text{mm}$, $> 5\text{mm} \pm 0.3\text{mm}$, the tolerance of PCB thru hole: $+0.2\text{mm}$

备注: 尺寸公差 $\leq 5\text{mm} \pm 0.2\text{mm}$, $> 5\text{mm} \pm 0.3\text{mm}$, 印刷电路板孔 $+0.2\text{mm}$

Y31 Reference Data 参考资料

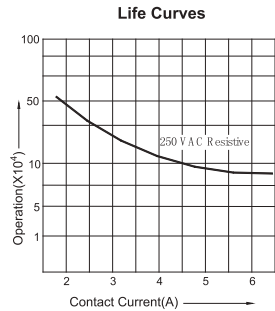
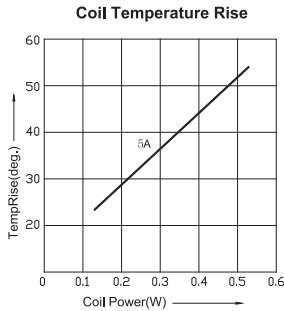
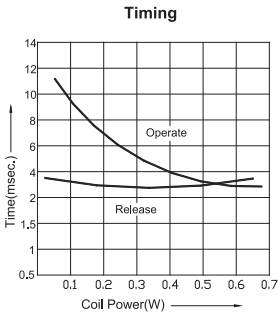

SAFETY STANDARD 安规认证

SAFETY 安规名称	Coil Voltage 线圈电压	Contact Rated 接点额定值
UL	DC : 5V~24V	5A 250VAC 3A 250VAC 5A 30VDC 1/8HP 240VAC
CQC		5A 250VAC 3A 250VAC
TUV		5A 250VAC 3A 250VAC
VDE		5A 250VAC 3A 250VAC

*CQC、TUV、VDE Application 申请中