

料号 material No.	品名 Parts Name	型号 Part NO.	接插规格 connecting spec	W	F	L	B	∅D	∅C	厚度
40-FDFN1.25-250	全绝缘接头	FDFN1.25-250	0.8*6.35	6.6	7.3	22.0	11.0	4.0	1.7	0.4

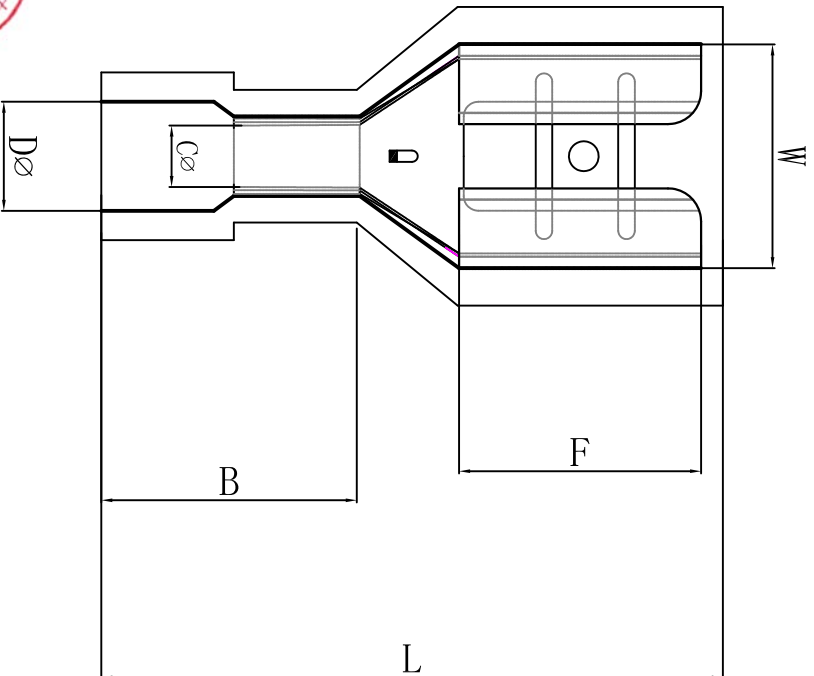

导线截面: 0.5-1.5mm² (美国线规22-16)
最大电流: I_{max}=10A
材 质: 黄铜
绝缘套材料: 尼龙



DIMENSION	TOLERANCES								
0.0 0.00	±0.5								
FRIST ANGLE PROJ		A	NEW PART						
		LTR.	REVISION RECORD	DWG. BY	CHK. BY	DATE			
				<i>wallian</i>	<i>ya wang</i>	<i>22/10/15</i>			
DWG. BY	<i>liu liang</i>	UNIT	mm						
CHK. BY	<i>wallian</i>	REV.	A						
APP. BY	<i>wang zhiqian</i>	DWG. NO.	HIMA/QR-JZ-40-FDFN1.25-250						

未经许可不得修改和复印
该知识产权属于技术质量部