

### Features

- Low  $I_R$ .
- High reliability.
- Small surface mounting.

### Applications

- Low current rectification



### Absolute Maximum Ratings (T<sub>amb</sub>=25°C unless otherwise specified)

Parameter	Symbol	Limits	Unit
DC reverse voltage	$V_R$	30	V
Mean rectifying current	$I_O$	200	mA
Peak forward surge current	$I_{FSM}$	1	A
Total device dissipation	$P_T$	200	mW
Junction and storage temperature	$T_j, T_{stg}$	-40 to +125	°C

### Electrical Characteristics (T<sub>A</sub>=25°C unless otherwise specified)

Parameter	Symbol	Min.	Max.	Unit	Conditions
Forward voltage	$V_F$	-	0.6	V	$I_F=200\text{mA}$
Reverse current	$I_R$	-	1	μA	$V_R=10\text{V}$

**Package Outline Dimensions**

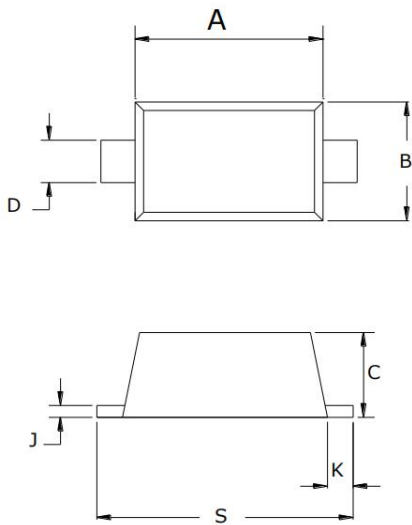

SYMBOL	Dimensions In Millimet	
	MIN	MAX
A	1.10	1.30
B	0.70	0.90
C	0.50	0.70
D	0.25	0.35
J	0.07	0.20
K	0.15	0.25
S	1.50	1.70