

REV.	ECN. NO.	APPD.
A		

NOTES:  
 Current Rating:1.5AMP  
 Contact Resistance:20mΩ max  
 Withstand Voltage:500V AC/DC  
 Insulation Resistance:1000MΩ min  
 Operation Temperature:-40°C to +105°C

Contact Material:Brass  
 Contact plating:Au or Sn Over Ni  
 Insulator Material:PA6T+30%GF(UL94V-0)

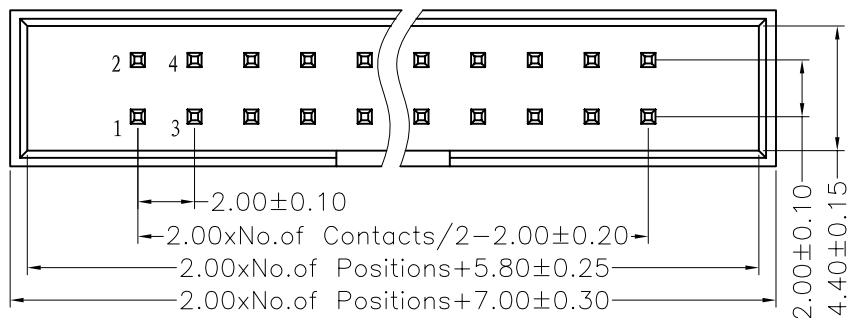

Recommended P.C.B Layout(Top Side)  
 (PCB BOARD TOLERANCE±0.05)

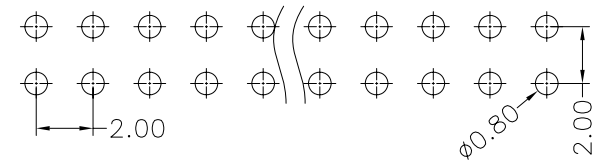

**MTB11-XXS**

No.of Pins	
6P	24P
8P	26P
10P	30P
12P	34P
14P	40P
16P	50P
18P	60P
20P	64P

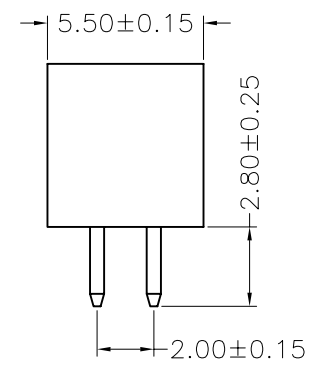
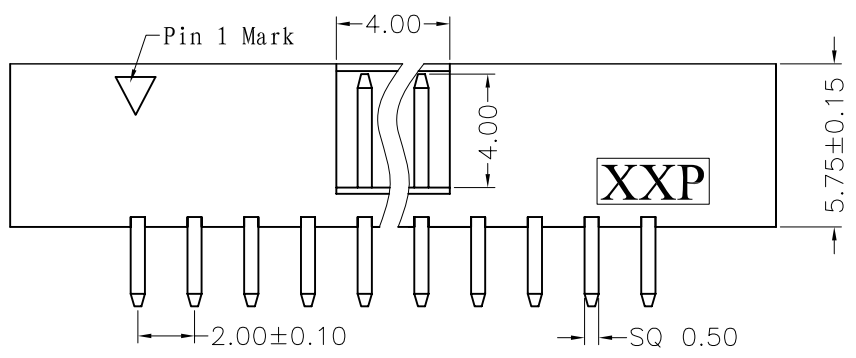

X. ± 0.30	X.° ± 5°	UNITS mm	NAME(INTENDED USE)	MINTRON CO.,LTD.			
.X ± 0.20	.X° ± 2°	MAT'L	PART NO.(INTENDED USE)				
.XX ± 0.10	.XX° ± 1°	FINISH	APPD: SUNNY	TITLE: MTB11-XXS			
.XXX ± 0.05	.XXX° ± 0.5°		CHKD: LISA	DWG NO.:			
BOX HEADER CONNECTOR			Q'TY	DR: ZOE 2006-11-28			
			<table border="1"> <tr> <td>SCALE</td> <td>SHEET</td> <td>REV.</td> </tr> <tr> <td>1/1</td> <td>1/1</td> <td>A</td> </tr> </table>		SCALE	SHEET	REV.
SCALE	SHEET	REV.					
1/1	1/1	A					