

# APPROVAL SHEET

To :

Customer P/N :

UDE P/N : 2F-ZZ-0002

Description : RJ45 1X4 Tab Up  
Through Hole  
10/100/1000 Base-T  
Contact Area : Gold Flash  
LED: L-Green/Orange;R-Green



Spec No.  
2F-16003-00

Update Date  
2016/10/11

Revision  
A

Approved	Checked	Prepared



湧德電子 股份有限公司  
UDE Corp.

8F-1, No.58, Tongde 11th St., Taoyuan City, Taoyuan County (330), Taiwan  
桃園縣桃園市(330)同德十一街58號 8F之1  
TEL:+886-3-3568600 FAX:+886-3-3560611  
<http://www.ude-corp.com/>

1. MECHANICAL DIMENSION

1.1 Product Dimension

Unit:mm	General Tolerance :	X.X : ± 0.38
		X.XX : ± 0.20

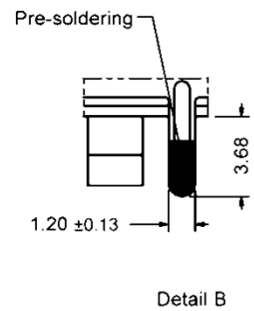
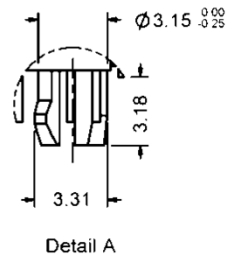
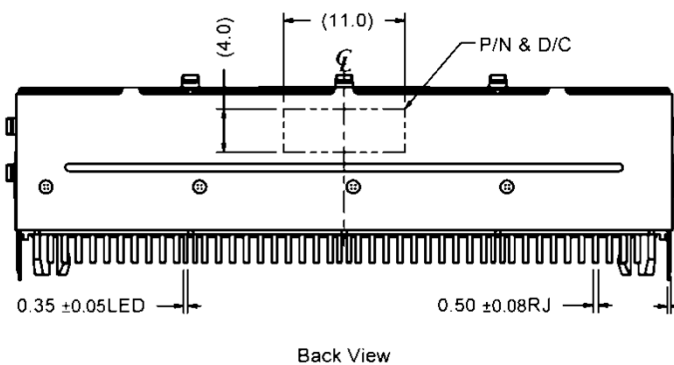
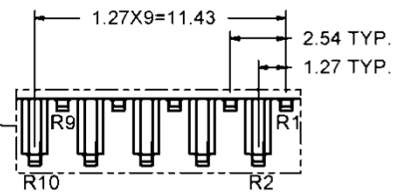
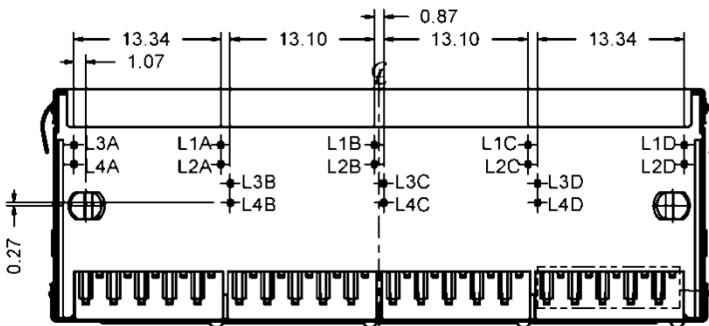
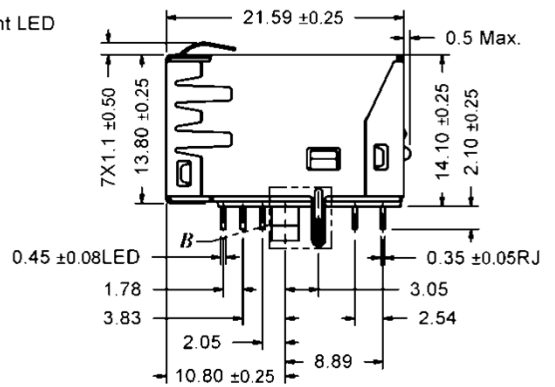
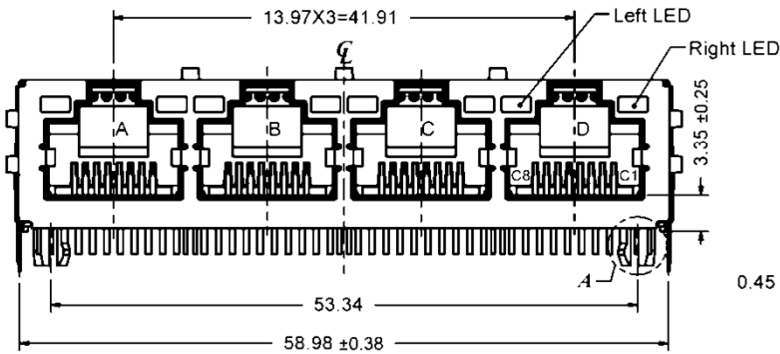
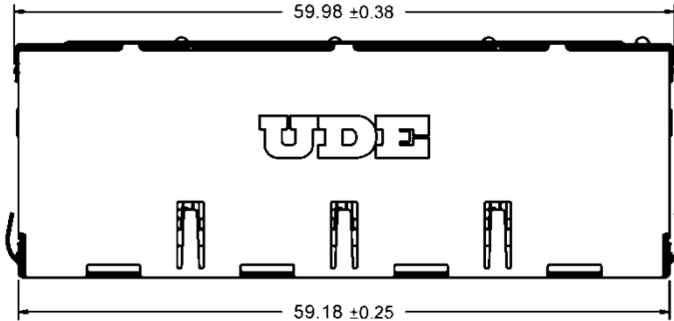



### 1.3 Recommended Panel Cutout

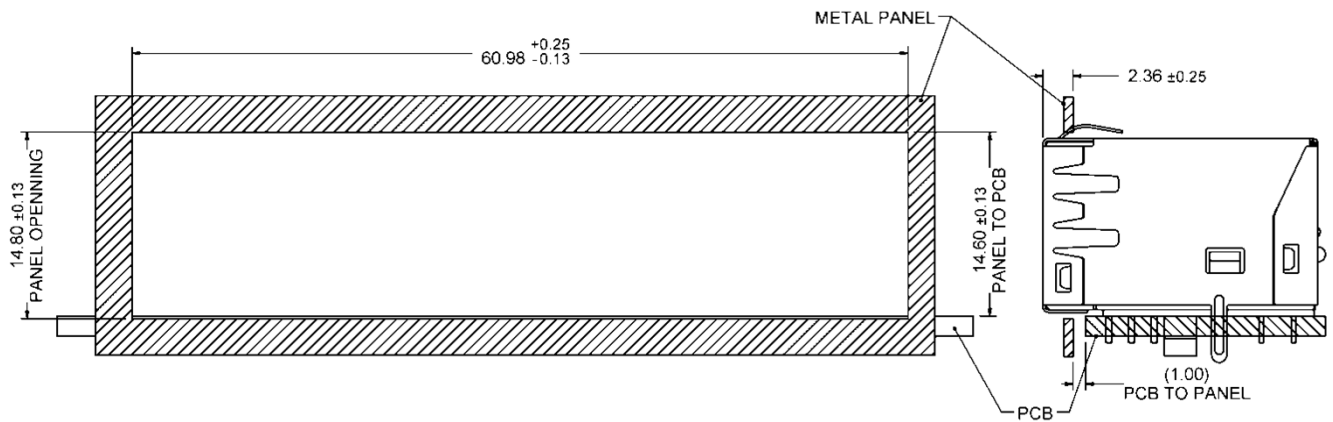

### 1.4 Packing Information

20 pcs finished goods per tray

6 trays(120 pcs finished goods) per inner box

4 Inner boxes(480 pcs finished goods) per master carton



## 2. REQUIREMENTS

### 2.1 Design and Construction

Product shall be of design, construction and physical dimensions specified on applicable.

### 2.2 Material

#### 2.2.1 Terminal Parts (Underplating : 50 $\mu$ " min. Nickel overall)

2.2.1.1 RJ Terminal : Phosphor Bronze, Thickness=0.30mm

Finish : Contact Area : Gold Flash

2.2.1.2 Input Terminal : Brass, Thickness=0.35mm

Finish : 100 $\mu$ " min. Matte. Tin

2.2.1.3 LED Terminal : Brass, Thickness=0.35mm

Finish : 100 $\mu$ " min. Matte Tin

2.2.1.4 Case Terminal : Brass, Thickness=0.30mm

Finish : 100 $\mu$ " min. Tin

2.2.1.5 Capacitance Terminal : Phosphor Bronze, Thickness=0.35mm

Finish : 100 $\mu$ " min. Tin

#### 2.2.2 Plastic Parts <UL94V-0>

2.2.2.1 Housing : PA6T, Black

2.2.2.2 Case : PA6T, Black

2.2.2.3 RJ Insert Molding : PBT, Black

#### 2.2.3 Shield Parts

2.2.3.1 Shield : Stainless Steel, Thickness=0.20mm, Pre-soldering

### 2.3 Operating and Storage Temperature

Operating Temperature : -40°C to +85°C

Storage Temperature : -40°C to +85°C

### 2.4 RJ45 specifications

Insulation Resistance 500MΩ min.

Insertion force with the latch depressed 22N max

Removal force with the latch depressed 44N max

Locking Force of Plug Latch : 50N min. @ 60+/-5 sec

Durability : 750 cycles

### 2.5 Performance and Test Description

Product is designed to meet electrical, mechanical and environmental performance requirements specified in below table. All tests are performed at ambient environmental conditions per MIL-STD-1344A and EIA-364 unless otherwise specified.

### 2.6 Packaging and Packing

All parts shall be packaged and packed to protect against physical damage, corrosion and deterioration during shipment and storage.

### 3. ELECTRICAL CHARACTERISTICS @ 25°C

#### 3.1 Schematic

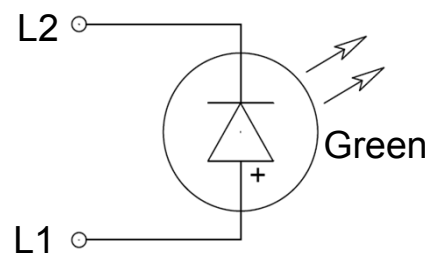
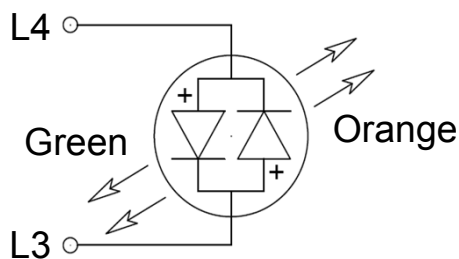
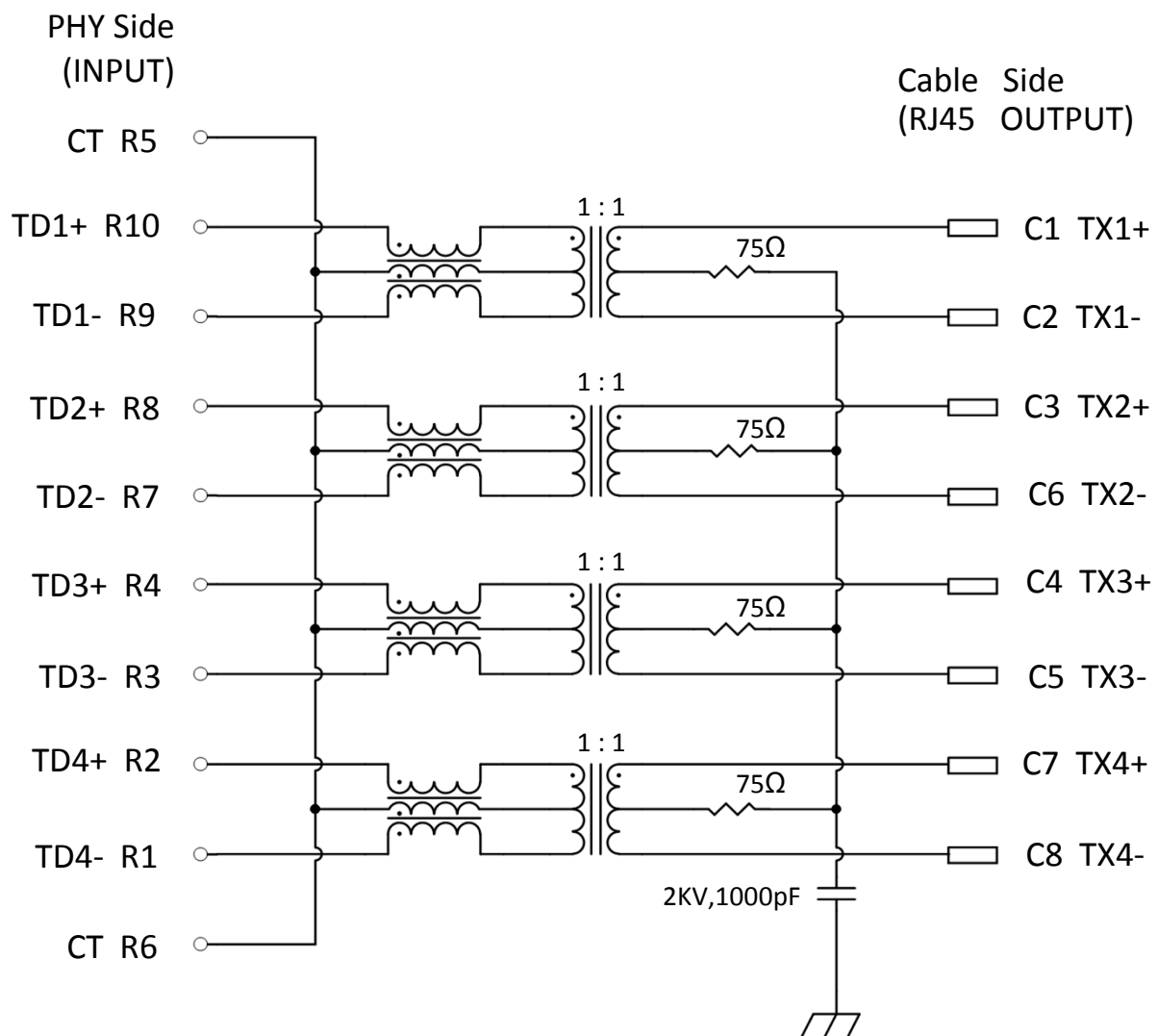

Emitting Color	$\lambda_p$ (nm)	$V_f @ I_f=20mA$	$I_r @ V_r=5V$
Green	570	1.7 ~2.6 V	10 $\mu$ A max.
Orange	605	1.7 ~2.6 V	10 $\mu$ A max.



### 3.2 Transmitter filter & Receiver filter

Type : Balance low pass 100Ω impedance

Insertion loss : 1~100 MHz -1.0dB max.

Return loss : 1~30 MHz -18dB min. load 100Ω

30~60MHz -16dB min. load 100Ω

60~80MHz -12dB min. load 100Ω

80~100MHz -10dB min. load 100Ω

### 3.3 Common Mode Rejection

@ 1~100 MHz -30dB min.

### 3.4 Cross Talk

@ 1~100 MHz -30dB min.

### 3.5 Inductance @ 100KHz, 0.1V, 8mA DC BIAS

Input (R10-R9), Input(R8-R7), Input (R4-R3), Input(R2-R1): 350 μH min.

### 3.6 HiPot Test

Input(R10-R9) To Output(C1-C2) : 1500Vac 60s or 2250Vdc 60s

Input(R8-R7) To Output(C3-C6) : 1500Vac 60s or 2250Vdc 60s

Input(R4-R3) To Output(C4-C5) : 1500Vac 60s or 2250Vdc 60s

Input(R2-R1) To Output(C7-C8) : 1500Vac 60s or 2250Vdc 60s

## 4. DIPPING TEMPERATURE PROFILE

Note:

The measuring point for the specified temperature shall be on the soldered part of the lead.

